



Carbon Fiber 9500 Folding Electric Wheelchair Owner's Manual



**Model #
MM-CARBON-W4**



Table of Contents

Welcome	2
Chair Specifications	3-5
Unpacking and Setting Up	6
How to Unfold, Fold and Strolling the Wheelchair	7-9
Transporting the Wheelchair and Lifting Armrest	10-11
Transferring onto and off of the Wheelchair	12
Joystick	13-14
Battery Information	15-19
Electric Mode vs Manual Mode	20-21
Additional Features	22-24
Basic Operation	25
Safety Precautions	26-29
Maintenance & Electromagnetic Interference	30
Warranty	31
Customer Service	32

Welcome

Thank you for choosing the Miracle Mobility Carbon Fiber 9500 Folding Electric Wheelchair. This is Miracle Mobility's most advanced power wheelchair. Miracle Mobility is an industry leader in medical mobility. Your wheelchair is designed to provide years of use. You have taken an essential step to regain mobility, independence, and freedom.

Please read this owner's manual before attempting to operate your Carbon Fiber 9500 Folding Electric Wheelchair. The safety and operating instructions will help you to understand the performance and limitations of your new power mobility chair.

If you need assistance, we have provided in-depth videos on the Miracle Mobility website at www.miraclemobility.com. Or contact technical support at **1-888-375-7128**. The actual product may have some slight differences due to random modifications or running change improvements from the factory.

Thank you for your purchase!

Miracle Mobility Development Team
1-888-375-7128
customerservice@miraclemobility.com



Chair Specifications



Easily navigate through standard doors and narrow hallways.

Folds in less than 3 seconds and fits in the trunk of most small cars.

Color Options	Black Carbon
Model #	MM-CARBON-W4
UPC Code	8-500121-19851-2
Motor Type	Magnetic Brushless DC Motor
Motor Power Rating	250 Watts x 2 (500 Watts Total)
Weight Capacity	297 lbs
Chair Weight w/o Battery	39 lbs
Chair Weight w/Battery	43 lbs
Maximum Speed	3.75 mph
Speed Settings	5 Speeds
Driving Distance	15 miles
Incline Grade Capacity	12 degrees
Battery Type	Lithium Ion Battery
Battery Capacity	24V/10AH
Batteries Per Unit	1 Battery
Charge Time	4-6 hours
Joystick Controller	DC24V/2A
Charger	Class 2 24V/1.5
Brakes	Intelligent Electromagnetic
Seat Size	17" W x 17" D
Unfolded Dimensions	34" L x 37" H x 23" W
Folded Dimensions	12" L x 27" H x 23" W
Tire Material	Solid Polyurethane & Rubber
Front Tire Size	7"
Rear Tire Size	9"
Frame Construction	Carbon Fiber
Gross Shipping Weight	53 lbs
Carton Dimensions	14" x 25" x 30"
Carton Cube	6.3
Warranty	3 yrs (frame), 2 yrs (motor), 1 yr (parts)
USB Charging Port	Yes



Load Capacity
297 lbs



Wheelchair Weight
(w/o Batteries)



Speed - 3.75 mph



Travel Distance
15 Miles



Power - 500 Watts

**Joystick Controller
with USB charger**

Padded Push Bar

Upgraded Back Padding

Armrest Lift Lever

Rear Shocks

Battery

9" Rear Wheels

Front Shocks

7" Front Wheel

Foot Rest Lifts



Miracle Mobility

Joystick Controls



Unpacking and Setting UP

1. Begin by taking out the wheelchair and spare parts from the shipping carton, remove packing wrap, and stand the chair upright. *(see Image 1)*
2. Install the joystick controller on the armrest.
The joystick can be installed on the left or right hand.
(see Image 2)
3. Make the joystick connection to the battery cable as shown *(see Images 3 & 4)* and tighten connection



Image 1



Image 2



Image 3



Image 4

How To Unfold

4. To unfold the wheelchair, grasp the push bar and hold down the seat bar to separate and expand the chair to the open position (*see Image 5*)
5. You will hear the safety clip lock in place when the chair is fully expanded in place correctly. The chair will easily unfold like a baby stroller to a full seated position. (*see image 6*) (*note it will be easier if the wheels are locked in electric mode when unfolding...see page 20-21 for details.*)

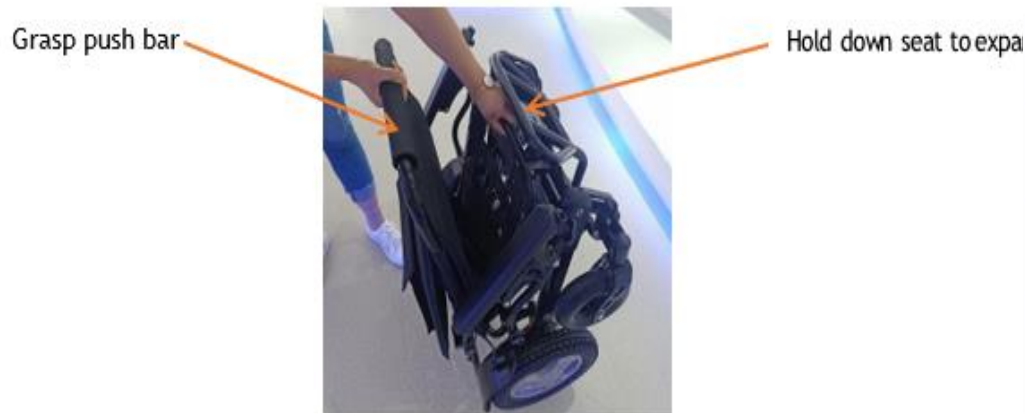

Image 5



Always make sure the power is off while unfolding and folding the wheelchair

How To Fold

6. Lift the safety clamp found on the back of the chair to unlock your chair and push the backrest slightly forward about 1 inch to separate the frame then release the clamp. (see image 7)
7. Push the chair forward all the way to the ground. It will fully collapse. (see images 8)
8. Now lift the chair (vertically) upright and it will stand by itself. (see image 9)



Image 7



Images 8



Image 9



Note: Insure the safety clamp is locked in place when unfolded. You will hear a clip when it is engaged. Failure to do this could result in the chair collapsing on you causing serious injury. Careful as this is a potential pinch point for fingers

How to Stroll the Wheelchair

9. Make sure the chair is powered off
10. Switch the break levers to manual mode (back toward you) (See image 10).
11. Once folded you can pull the wheelchair using the footrest (see image 11)
12. You will know if the wheelchair is in electric mode if the wheels do not turn.
13. Place chair in manual mode with the power off and the wheels will turn.
14. You can pull the Carbon Fiber 9500 wheelchair from the footrest on the rear wheels

Image 10

Brake Levers



Image 11



Transporting the Wheelchair in a Car

- 15. The Carbon Fiber 9500 wheelchair will fold to the size of a large suitcase. (see image 12)
- 16. When folded it is one of the smallest wheelchairs in the market (23" W x 12" H x 27" L) and can be easily carried (see image 13)
- 17. The Carbon Fiber 9500 requires little trunk space.
- 18. It is only 12" high when laid flat and 27" deep and 23" wide. This will allow plenty of room to fit within most trunk spaces.
- 19. The vehicle shown has a trunk that is 17" height and 36" wide and is 46" deep. (see Images 14 & 15)



Image 12

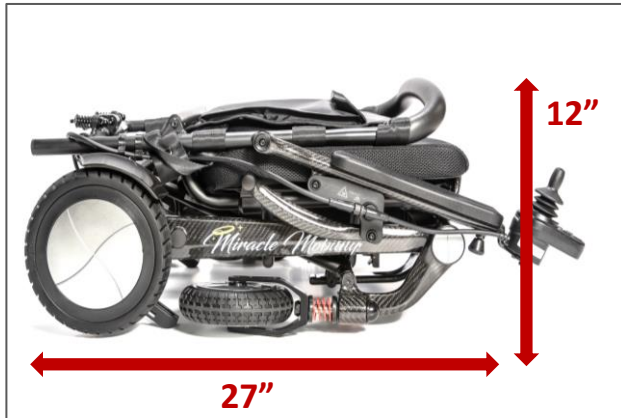

Image 13



Image 14



Image 15

Lifting The Armrest

20. Notice the armrest release button on the outside of each armrest (see image 15)
21. This button is in the locked position when the armrests are down
22. You will not be able to lift the armrest when the armrest lever is in the locked position
23. Press the armrest release lever and then lift the armrest up vertically
24. **Do not force the armrest down it should glide down gently.** If it gets stuck in the up position pull the lower bar forward, (see Image 16)



Transferring to the Wheelchair

- 25. Before sitting, make sure the power is OFF.
- 26. If you accidentally touch the joystick with the power on the wheelchair could move.
- 27. Make sure the footrest is down with feet placed on the footrest while using the wheelchair.

Transferring from the Wheelchair

- 28. Make sure to bring the wheelchair to a complete stop.
- 29. Turn the power off to avoid touching the joystick and moving the wheelchair unintentionally.
- 30. Raise armrest to conveniently transfer from the side of the wheelchair. (see Image 17)
- 31. Carefully slide forward and lower the armrest back in place.
- 32. Do not transfer off the wheelchair from the front.
- 33. Only transfer from the side of the wheelchair. (see Image 17)



Image 17



Joystick Controller

The joystick is designed to provide all the information you need to safely operate your wheelchair. (see image 18)

Image 18



The Carbon Fiber 9500 is designed to operate the chair with a zero-turn radius (*within its own footprint*) and will detect micromovement of the joystick.



To stop the chair simply let go of the joystick and the chair will come to a controlled stop.

Practice using the joystick to move forward and in reverse and making left and right turns.



Always use slow smooth movements and avoid jerky movements with the joystick

It takes about a week to get use to the joystick operations to become proficient. You will need to get a “feel” for the joystick’s responsiveness and drive accordingly

Joystick Controller

34. Practice operation in a safe and controlled environment to learn the operation of your 360-degree joystick along with the different speeds and the maneuverability of the wheelchair. (see image 19)
35. When turning, reduce your speed, which will help you avoid any potential tilting or tipping of the wheelchair and adjust the speed depending on your environment.
36. To stop, simply let go of the joystick and it will naturally return to the neutral position and bring the chair to a comfortable stop.

Image 19



Recommendations:



Operate the wheelchair slowly and at an even controlled speeds



Avoid sharp jerky movements of the Joystick. Make smooth movements for better responsiveness of the joystick



Make sure your path is clear of obstacles

Battery - Charging the Battery

37. Make sure the battery is installed correctly on the battery rail under the front seat (see image 20)
38. Make sure battery is clipped in place properly. If the battery is installed incorrectly, it will affect the function of the chair if installed incorrectly.
39. You can charge your battery from the joystick by connecting the 3-prong charger to the joystick as shown. (see Image 21)

NOTE: It is easiest to slide the battery in and out if the chair is folded upright

Image 20



Image 21

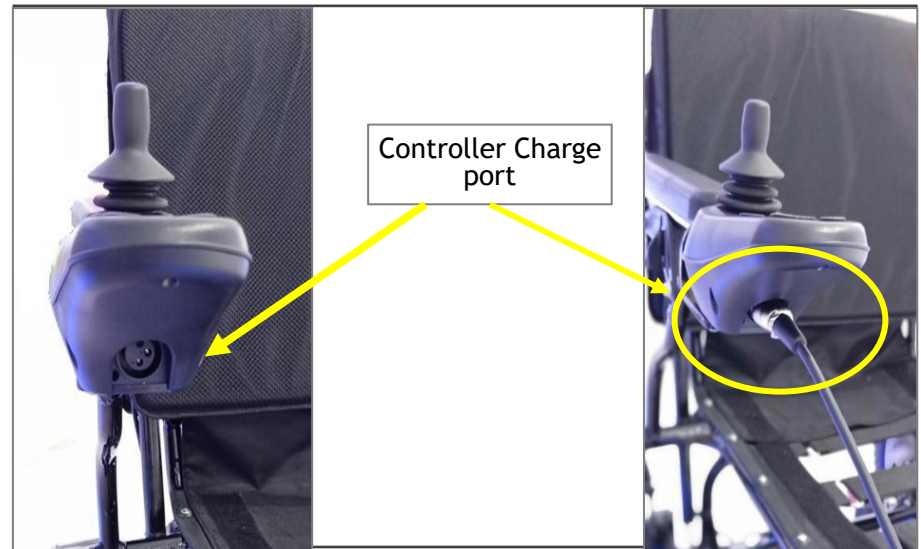

Charging The Batteries

40. The wheelchair uses a 24V10ah lithium Ion Battery. Your wheelchair will arrive with a partially charged battery.
41. The battery should allow you to drive for a distance up to 15 miles under normal operation conditions.
42. The battery can also be removed from the chair and charged using the battery charging port (see image 22)
43. Allow your wheelchair to charge for 4-6 hours or until the light on the charger turns green (see image 23)
44. Continue to charge the wheelchair 1 hour after the light turns green to fully charge the battery. Once fully charged, remove the cable, remove the DC charging connector from the AC input power socket.
45. If the wheelchair is unused for two months, you should charge the battery to keep it full before use.

Image 22

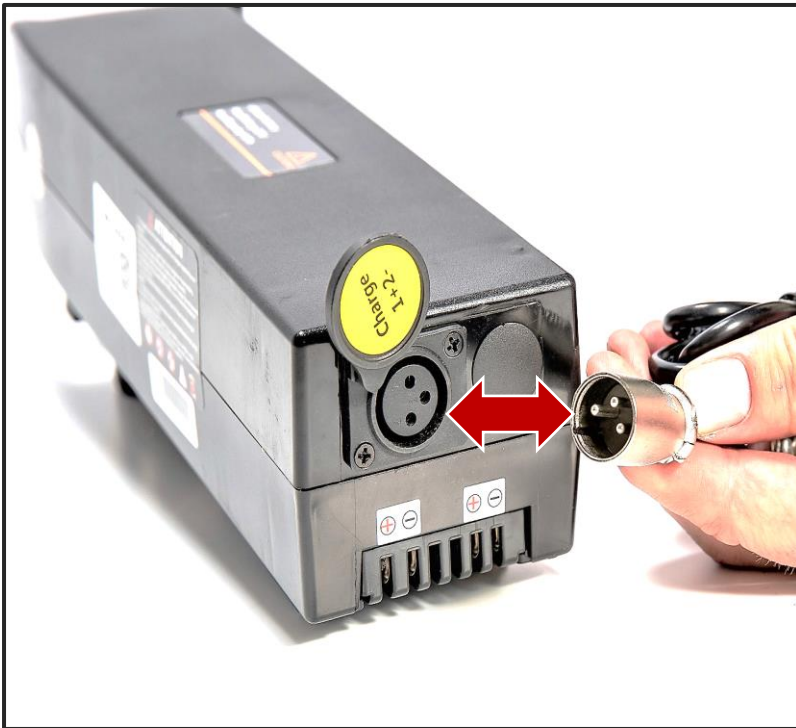

Image 23



Charging The Batteries

Charger Light (see image 24)

RED--battery is full drained

ORANGE-- battery is charging

GREEN-- battery is fully charged

(Image 24)



- 46. The Charger is an important part of your wheelchair and provides energy to your wheelchair through a safe, fast, and easy charger.
- 47. The wheelchair is a maintenance free design however we recommend you check the following:
 - a) Keep the charger and joystick away from moisture and check the battery connections to ensure they are not corroded
 - b) Do not wash your wheelchair. You can clean it with a wet wipe or clean damp cloth
 - c) Storage should be in a clean room with less than 80% humidity and at temperatures between 40 degrees to 105 degrees



The battery can be damaged if exposed to high temperatures

Battery Information

Remove the Battery

48. It is easiest to remove and replace the battery when the chair is folded and upright. Locate the battery (see Image 25)
49. Release the locking lever on the bottom of the battery to disengage the battery clamp from under the battery rail and then slide the battery forward. (see image 26)
49. The Carbon Fiber 9500 is powered by a Lithium Ion Battery that is a 24V 10ah battery. (see image 27)

Important Notes

50. This battery fully complies with FAA standards for passenger airline travel.
51. The battery will need to be removed from the wheelchair and carries inside your carry-on luggage.
52. You are required to inform the airline in advance of your battery

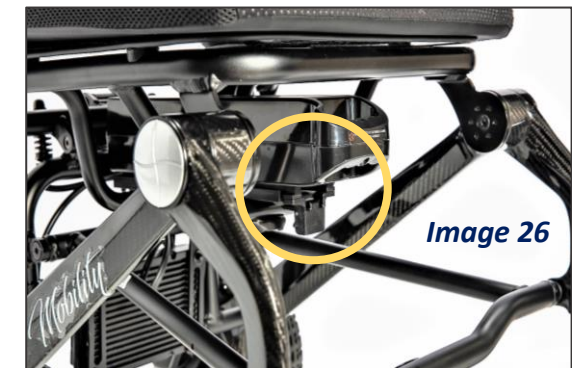
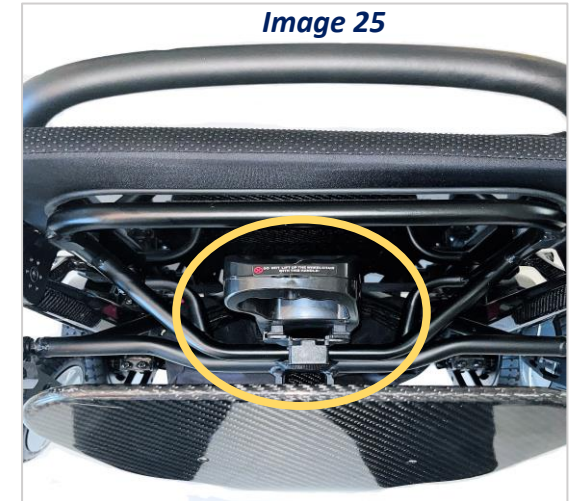

More Battery Information

- 53. The chair is equipped with over current protection. This added safety system is included on the wheelchair and will shut off the electrical current from the batteries if triggered, thus shutting the motor down. This will ensure that the motor and battery do not experience damage.
- 54. The life cycle of a lithium battery is measured in charging cycles with an average of 400 charge cycles.
- 55. Check the battery indicator light before each use to ensure you have the power you need.
- 56. Do not use a battery charger that have not been certified by Miracle Mobility.
- 57. If the battery is damaged, do not handle the battery without protective gloves and eyewear.
- 58. If the battery needs to be disposed of, locate the nearest hazardous materials disposal facility, and call for instructions.
- 59. If storing your wheelchair for an extended period, take these steps to maintain the battery:
 - ✓ Fully charge the battery before storing.
 - ✓ Remove the battery from the wheelchair.
 - ✓ Store the battery at a room temperature with a dry environment.
 - ✓ Avoid temperature extremes and do not allow the battery to freeze.

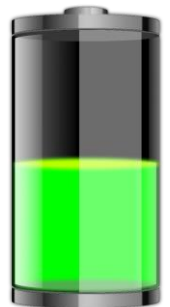

Do not attempt to charge your battery if it is frozen from extreme weather conditions, instead first allow it to thaw for several hours.

Electric Mode vs Manual Mode

- 60. A care giver can push the power wheelchair. Both wheels of the wheelchair must be in manual mode allowing the wheels to move freely. (see image 28)
- 61. Turn off the power from the joystick if the chair is powered on while in manual mode. A beep will warn you to turn off the power. If the power is on you will not be allowed to push the wheelchair even if the chair is in manual mode.
- 62. Switching from Electric Mode to Manual Mode can be done by flipping the brake levers on the back of the wheelchair. (see image 28)

Brake Levers



Image 28

Electric Mode vs Manual Mode

Troubleshooting

- 63. If the power is turned off and the brake levers are in electric mode, the wheels will not turn manually.
- 64. You will not be able to push the wheelchair if the wheels are locked in electric mode with the joystick off.
- 65. Both wheels need to be in the same position (electric or manual) for the chair to function correctly.
- 66. Pull the brake levers back towards you to engage the manual mode with the joystick turned off and the wheels will turn freely allowing you to push the wheelchair. (See image 29)

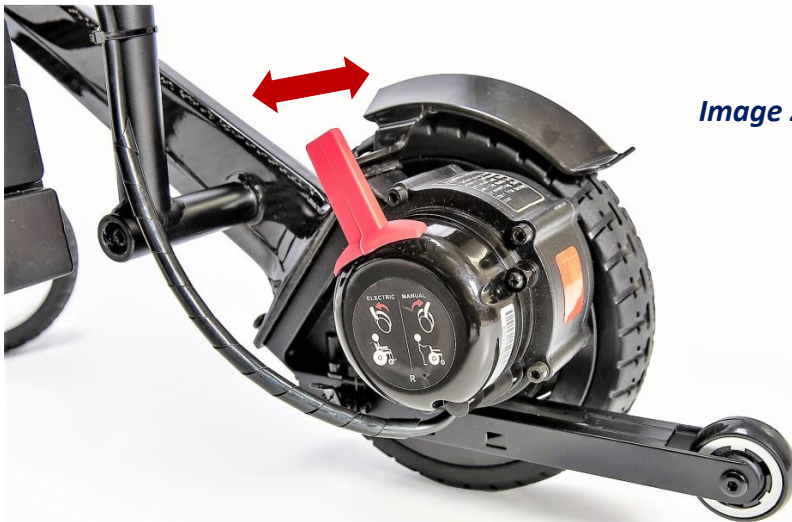
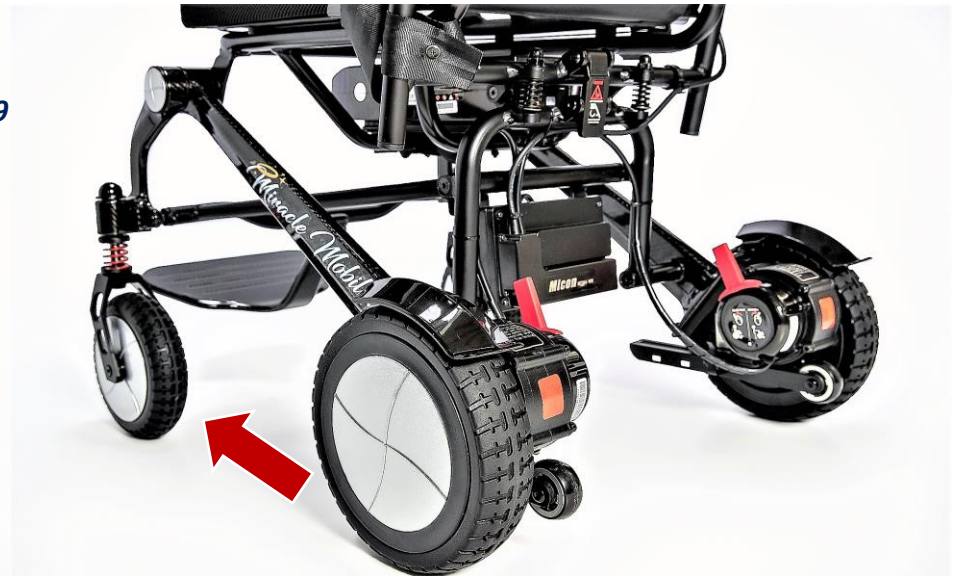

Image 29



Additional Features



Carbon Fiber Lifting Footrest

The Carbon Fiber 9500's footrest can lift out of the way to make for easy transfer onto and off the wheelchair. The footrest is constructed of Carbon Fiber and is an ultra lightweight footpad that provide a nice platform to rest your feet while driving your wheelchair.



Carbon Fiber Construction

The Carbon Fiber 9500 has a frame construction made of a 65% lightweight carbon fiber.

This is Miracle Mobility's highest quality power mobility chair weighing 39 lbs without the battery and 43 lbs with battery installed making it the lightest weight power mobility chairs in the market.



Never a Flat Tire

The tires are made of a solid polyurethane and rubber material and are equipped with a dust free wheel cap. They offer a soft comfortable ride with exceptional grip. Drive worry free as you will never have a flat tire. The front tire measures 7" and the rear tire measures in at 9".

Additional Features



Upgraded Embroidery Foam Backrest Cushion

The Carbon Fiber 9500 backrest is equipped with a high-density single cell foam backrest with reinforced padding. The seat measures 17" x 17". The seat cover can be removed and is machine washable.



Front Suspension Shocks

The Carbon Fiber 9500 wheelchair is equipped with two front suspension shocks over each front tire to provide one of the industries smoothest rides over uneven terrains. The shocks will help absorb pressure on your spine.



Rear Suspension Shocks

The Carbon Fiber 9500 wheelchair is equipped with two rear seat suspension shocks to provide a smooth ride over uneven terrains. The suspension shocks help to provide the smoothest ride possible letting you enjoy hours of use without feeling sore after sitting for long periods of time.

Additional Features



USB Port and drive with Left or Right Hand

The joystick can be mounted on the left or right hand. The length of the joystick can be adjusted to comfortably fit each users arm length. The joystick can also be easily removed for safe transport of the wheelchair. It is also equipped with a USB port for mobile device charging.



Additional Storage

The Carbon Fiber 9500 has two storage compartments one located on the back of the seat backrest. (13" W x 10.5" H x 2" D) . The second storage bag is located under the seat with front entry access. (10" W x 8" D x 5" H)



Anti-Tipping Wheels

Anti-tipping wheels are located at the back of the Carbon Fiber 9500 wheelchair and can be extended back to provide and additional safety measurement improving the center of gravity while navigating up slopes.

Basic Operation

Before operating your wheelchair, be sure to read all safety information and precautions included in this manual. Operate only in an appropriate environment.

TRANSFER ON	Be certain that the power is OFF before sitting in the seat of Silver Plus 6000 Wheelchair. There should be no lights on the controller and always board with a side transfer.
POWER ON	Press the power button, you will hear a beep and the joystick lights will indicate that the power is on.
TURING &STEERING	Use the joystick style controller to steer left or right, forward or in reverse.
STOPPING	Simply remove your hand from the joystick to stop.
POWER OFF	When stopping, it is advised that you power OFF the wheelchair to prevent accidents. Press the power button to turn off the wheelchair and the joystick lights will shut off.
GET OUT	Make sure there is no lights on the controller before getting off the wheelchair.



Practice in an open space before operating. Find an open area such as a park and have an assistant to help you practice until you can operate this vehicle skilled.



Always make sure that the power is off before transferring on or off the seat.



Set the speed control button according to your driving speed preferences. We recommend you keep the speed at the lowest shift setting until you are familiar with the driving characteristics of the joystick.

Safety Precautions



Please Do Not

- ✓ Do not operate in water
- ✓ Do not operate on stairs or escalators
- ✓ Do not operation while on a moving vehicle such as a bus
- ✓ Do not exceed the weight capacity of 297 lbs
- ✓ Do not expose the battery to extreme temperatures over 105 degrees
- ✓ Do not carry additional passengers it is for a single use passenger
- ✓ Do not drive parallel with a slope (see image 30)
- ✓ Do not attempt to climb slopes greater than 12 degrees and lean forward to improve center of gravity (see image 31)

Please Do

- ✓ Please turn off the wheelchair prior to exiting the chair
- ✓ Please practice driving the wheelchair in a controlled environment
- ✓ Please be aware of local laws regarding operating wheelchairs on public roads
- ✓ It is recommended to always use sidewalks
- ✓ Please note modifying the wheelchair may void all warranties
- ✓ Always keep your feet on the footrests while driving
- ✓ Do come to a complete stop before turning off the joystick.
- ✓ Turning off joystick while in operation can cause damage to the joystick controller

Image 30



Image 31

Safety Precautions



Always

- ✓ Always engage the slowest speed setting when going down hill
- ✓ Always use the safety belt
- ✓ Always make sure the batteries are fully charged before setting out on a journey
- ✓ Always charge the power wheelchair in well ventilated areas to prevent possible risk
- ✓ Always check to make sure there are no obstacles behind you when backing up
- ✓ Always keep speed at the slowest setting in reverse
- ✓ Always avoid irregular shaking or emergency turning
- ✓ Always drive at a safe and predictable manner
- ✓ Always keep arms on the armrests and feet on the footrest
- ✓ The footrest will lift out of the way making transfer on and off easier (see Image 32)
- ✓ Always use a slow speed when going downhill
- ✓ Always supervise children near the wheelchair while it is charging.

Image 32



General Safety Precautions

- ✓ Do not lean over the front or side of the wheelchair as this can cause a tipping situation. (see images 34 & 35)
- ✓ Do not transfer on/off the wheelchair from the front. This can cause a tipping situation. (see image 33)
- ✓ Always perform a side transfer onto and off of the wheelchair. (see image 36)
- ✓ If you are unsure if the wheelchair can safely clear an obstacle, find another path.
- ✓ Make sure all electronic components (control panel, battery charger, and other electronic controlled components) avoid moisture. If these components come into contact with moisture, dry before use.



Image 36



Image 33



Image 34



Image 35



Safety Precautions



Do not exceed the weight capacity or the warranty will be voided

- ✓ Never exceed a total weight of 297 lbs total for the rider plus items carried.
- ✓ Exceeding the weight limited is likely to damage the seat, frame or fasteners and may cause severe injury to you or others.

When transporting the Carbon Fiber 9500 Wheelchair

- ✓ Never sit in the wheelchair while in a moving vehicle; an accident or sudden stop may cause you to be thrown from the electric wheelchair.
- ✓ Never transport the wheelchair in the front seat of a vehicle where it may shift and interfere with the driver.
- ✓ Always secure the wheelchair so that it cannot roll or shift when being transported in a vehicle.
- ✓ The wheelchair is NOT approved to be used with any tie down system with a passenger in the seat of a motor vehicle.

Driving the Carbon Fiber 9500 Wheelchair

- ✓ Be alert to the danger of motor vehicles on roads or in parking lots.
- ✓ At night or when it is hard to see, use reflective tape on your wheelchair.
- ✓ The wheelchair is designed for use on firm even surface such as concrete, asphalt or indoor floor.
- ✓ Do not operate the wheelchair in sand, loose soil or over rough terrain, which could damage wheels, bearings, axles or motors, or loose fasteners.
- ✓ Do not drive through standing water.

Maintenance

- ✓ It is important to perform regular maintenance of your wheelchair for longevity and warranty eligibility. Even a little cleaning now and again will go a long way to keep your device looking and functioning like new. Certified repair shops with trained professionals who specialize in electric wheelchairs and scooters will be qualified to perform the service and maintenance on your Wheelchair should a technician be required.
- ✓ We recommend you inspect your Wheelchair two or three times per year
- ✓ **Frame:** Tighten loose screws as necessary.
- ✓ **Wheels:** Make sure they rotate easily. Significant resistance may require new bearings.
- ✓ **Armrest:** Look for excessive wear or if they are loose.
- ✓ Replacement parts and major maintenance issues should be done by a professional.



Batteries

- ✓ Use batteries that have been supplied by Miracle Mobility; our batteries are special lithium batteries designed specifically for use in the Carbon Fiber 9500 wheelchair.
- ✓ Read all battery instructions before attempting to change or charge batteries.
- ✓ When not in use for extended periods, we recommend you charge the battery every month to avoid the battery “life” capacity is depleted and then a new battery will be required.

Electromagnetic Interference

- ✓ Powered vehicles such as the Carbon Fiber 9500 Wheelchair may be susceptible to electromagnetic interference, which is interfering electromagnetic energy emitted from sources such as radio station, TV station, amateur (two way) radio transmitters, two-way radios, and cellular phones.
- ✓ The interference (from radio wave sources) can cause the wheelchair to release its brakes or move in unintentional directions.
- ✓ If your wheelchairs experiences sudden movements due to electromagnetic interference turn off the electric wheelchair power until it is safe to resume use.
- ✓ It is recommended that you turn off mobile devices to limit the change of electromagnetic interference while driving your wheelchair.



Warranty

- ✓ The purchaser of this product is entitled to a limited warranty as offered by Miracle Mobility, and its affiliates on the following components and timeframes:
- ✓ Chair frame: 3 years, Motors: 2 years, Controller and CPU system: 1 year, Battery: 1 year
- ✓ Wearable parts not included are: tires, seat and back rest, armrests, and support straps are not included in the warranty.
- ✓ This warranty is valid for the replacement of dysfunctional parts only. Any parts under warranty will be replaced and shipped to your door. Any service and labor fees, if applicable, to replace parts under warranty must be paid by the user.
- ✓ Due to its straightforward design, most parts can be easily exchanged by the end user without a professional service tech required. However, it is always recommended you seek professional help for maintenance and service, to make sure the work is done properly.
- ✓ Please note modifying the wheelchair will void all warranties

The warranty does not cover:

- ✓ Products damaged by user negligence or abuse.
- ✓ Products damaged accidentally or intentionally.
- ✓ Products that have been improperly stored or mishandled.
- ✓ Products that have been improperly operated or have experienced general misuse.
- ✓ Products that have been modified in an unauthorized, unapproved way.
- ✓ Warranty is non-transferable and only valid for the original wheelchair purchaser.
- ✓ The warranty card is provided in the carton, or you can complete the warranty online at www.miraclemobility.com. Visit our Website for more details





24/7 CUSTOMER SERVICE AVAILABILITY

1-888-375-7128

Miracle Mobility LLC

13575 58th St. N #201

Clearwater FL 33760

customerservice@miraclemobility.com

*To learn more, check out the website for informational videos & purchase details at:
www.miraclemobility.com*

Google

5 Star Customer Rating



AAHOMECARE

American Association for Homecare

Proud member of the American Association for Homecare



"A" Rating for customer satisfaction & support



You Tube

Miracle Mobility